

### Features

- Dual, Pilot Operated Check Valves allow movement of an actuator connected to C1 and C2 ports, when pressure is applied to port V1 or V2. When there is no pressure at the V ports, the check valves prevent flow back through the C ports, holding the actuator in place if there is no other leakage path..
- Flow is allowed in one direction (V1 to C1 or V2 to C2).
- Flow is allowed in the opposite direction when sufficient pressure is applied to V2 (opens C1 to V1) or V1 (opens C2 to V2).

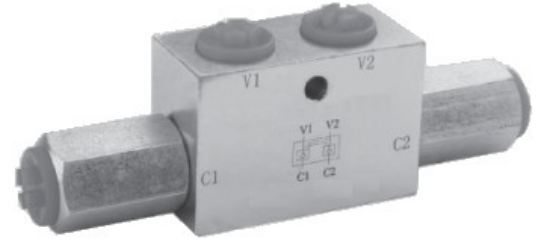

### Ordering Details

V	Valve
I	Inline connection
CPD-	Check, Pilot Operated, Dual Port
O8-	Port Size
1	Series:

Example Part Number: VIN-O8-1

Nominal Thread Size	Code NPTF Pipe Thread	Code SAE O-ring Boss
1/4"	N.25	O4
3/8"	N.37	O6
1/2"	N.5	O8
3/4"	N.75	O12

### Dimensions and Technical data

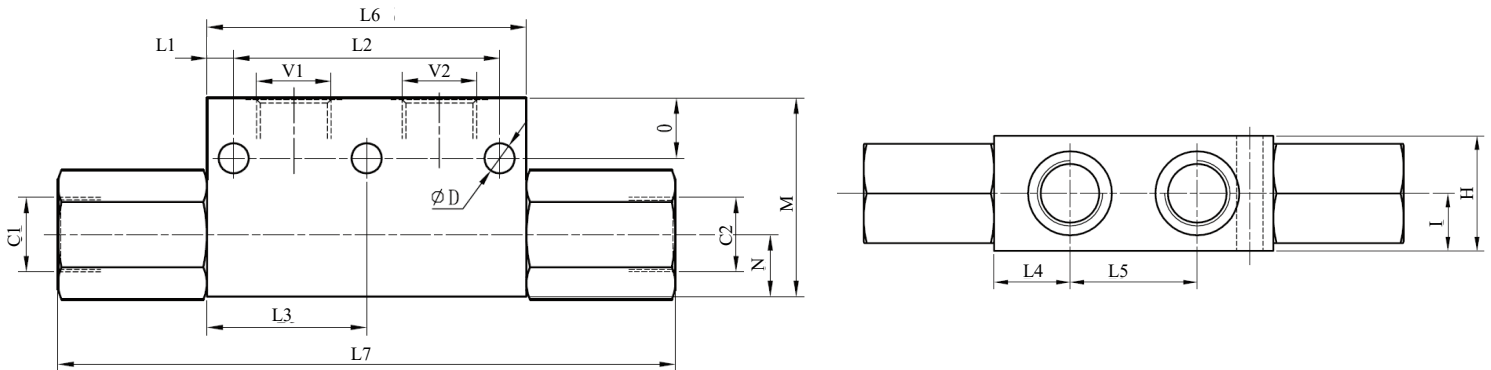

Size, V1, V2, C1, C2		Dimensions mm (inch)												
NPT	SAE	L1	L2	L3	L4	L5	L6	L7	O	N	M	I	H	ØD
N.25	O4	-	-	32.2 (1.27)	17.5 (0.69)	29 (1.14)	63 (2.48)	130 (5.12)	8 (0.31)	14.5 (0.57)	43 (1.69)	14.5 (0.57)	29 (1.14)	6.4 (0.25)
N.37	O6	-	-	32 (1.26)	17 (0.67)	30 (1.18)	64 (2.52)	120 (4.72)	9 (0.35)	13 (0.51)	40 (1.57)	15 (0.59)	30 (1.18)	6 (0.24)
N.5	O8	7.5 (0.30)	75 (2.95)	-	24.5 (0.96)	41 (1.61)	90 (3.54)	174 (6.85)	17 (0.67)	17.5 (0.69)	56 (2.20)	18.5 (0.73)	37 (1.46)	8.5 (0.33)
N.75	O12	8 (0.31)	104 (4.09)	-	30 (1.18)	60 (2.36)	120 (4.72)	213 (8.39)	16 (0.63)	25 (0.98)	70 (2.76)	25 (0.98)	50 (1.97)	9 (0.35)

Size		Max. Flow Rate	Max. Pressure,	Pilot ratio*
NPT	SAE	lpm (gpm)	bar (psi)	
N.25	O4	15 (4)	350 (5000)	4:1
N.37	O6	35 (9.2)	350 (5000)	5.2:1
N.5	O8	50 (13)	350 (5000)	4.3:1
N.75	O12	100 (26)	350 (5000)	3.9:1

\*The minimum ratio of pressure at the V port below the C port required to pilot open the check valve.